

PRODUCTIVE TEAMWORK

Combining strengths to accelerate the development of high-performance digital technologies

INNOVATIVE SPIRIT

Delivering frequent updates for more advanced dental applications and increased ease of use

TECHNICAL KNOW-HOW

Respecting the needs of the dental technician in the development of technological innovations

INSIDE

DIGITAL DENTISTRY

2017

N° 1

MILLING



ZFX AND FOLLOW-ME!

TEN YEARS
DEVELOPMENT
COOPERATION



ZFX INNOVATION

The place where new ideas are transformed into advanced dental design and manufacturing solutions ...

p. 2

HIGHLIGHTS DER ZFX INHOUSE 5X WET & DRY



NEW: Baltic Denture Milling

Zfx has integrated Merz Dental's Baltic Denture System into its own CAD/CAM solution. Using a CAM software upgrade and a specific blank holder, the compact wet & dry solution Zfx™ Inhouse5x is able to produce complete dentures from blanks with an integrated functional teeth setup.

NEW: Processing of Pre-Abutment Blanks

With a patented Zfx™ Pre-Abutment Blank Holder and a new CAM software module including the required milling templates, users of the Zfx™ Inhouse5x are able to produce individual abutments. The required titanium pre-abutment blanks are available with pre-fabricated implant connections for numerous different implant systems.



More about the
Zfx™ Inhouse5x online at
www.zfx-dental.com

FOLLOW-ME! AND ZFX: A TEN-YEAR SUCCESS STORY

More than a decade ago, the managers of the development stage enterprise Zfx (Oliver Hill and Andreas Geier) had an idea: Based on an existing software solution, the highly motivated team wanted to develop a high-end digital workflow solution with open interface architecture for the production of dental restorations. Their search for competent industry partners ended in a collaboration with industrial companies including SAUER (a company of DMG MORI), developer and producer of high-performance CNC machining centres, and CAM software specialist OPEN MIND. The development project was initiated in 2007 and in the same year, OPEN MIND formed a spin-off company, FOLLOW-ME! Technology, with Dr. Ferdinand Schwenkert as the CEO to focus on the development of a purely dental CAM software.



The collaboration came to fruition in 2009 when the complete production solution was presented for the first time. The precisely adjusted components – from a desktop scanner to a sintering furnace – were successfully put into operation in the first two Zfx™ Milling Centres opened in autumn 2009 in Altomünster near Munich, Germany and Ourense in north-western Spain.

In subsequent years, the companies Zfx and FOLLOW-ME! continued working together to optimize the software features and integrate new functionalities. Tasks were clearly assigned: FOLLOW-ME! brought in the team's profound knowledge around simultaneous five-axis milling strategies, while the Zfx team members contributed their dental know-how. This expertise was necessary for different purposes:

**“Joining forces with technology experts like FOLLOW-ME!
enabled us to develop a manufacturing solution
meeting the highest quality standards.”**

Andreas Geier, CEO Zfx GmbH

ZFX INNOVATION CENTER

Zfx is not only a distributor, but also a developer and producer of CAD/CAM components used for high-end manufacturing of diverse kinds of dental restorations. The company's development centre – Zfx Innovation – is located in Gargazon, a municipality in South Tyrol, Italy. Here, the scanner Zfx™ Evolution plus and the mill Zfx™ Inhouse5x were developed. In addition, a team of specialists is always working on customer-driven system improvements and testing new features and functionalities. In the context of an expansion, the Zfx™ Milling Centre was just relocated in a building across the street.



Milling machines being produced at Zfx Innovation in Gargazon near Bolzano, Italy.



“Our work with the Zfx team enabled us to better understand, and respond to, the needs of a dental technician that forms the basis of our long-term success in the dental industry”

Dr. Ferdinand Schwenkert, CEO FOLLOW-ME! Technology Group
together with Oliver Hill, CEO Zfx GmbH (left)

It was leveraged to ensure an intuitive use of the software to be operated by dental technicians – their specific work techniques and preferences had to be taken into account. In addition, the know-how was needed to ensure the expected high-quality outcomes (Zfx was able to assess the level of surface quality or precision needed when producing specific parts like screw channels and implant connections). In this way, the companies succeeded in developing high-end applications for the processing of individual abutments, screw-retained implant-based bridge frameworks and more made of diverse dental materials. This focus on implant prosthetics aroused the interest of Zimmer Biomet in 2011, which – after the merger with Zfx – also became a driver of continued innovation.

Finally, what was first developed for large machining centres e.g. provided by SAUER was modified to work in smaller production units like the desktop mill Zfx™ Inhouse5x launched in 2013. Its users also benefit from regular optimizations – made available in no small part due to the fruitful and durable partnership with FOLLOW-ME!.

Zfx Inhouse5x at a glance

- » **Compact 5-axis wet & dry solution with open interfaces**
- » **Automatic tool magazine with 28 positions**
- » **Automatic tool breakage control and length measurement**
- » **Multi-Block support for management of up to 15 blocks**
- » **Processing of zirconia, ceramic, composite, PMMA and wax**



A PERFECT MATCH **hyperDENT® V8 & Zfx™ Inhouse5x**

In late 2016, the latest *hyperDENT*® software update was released. The new version with updated milling templates is now also available for all users of the compact 5-axis unit Zfx™ Inhouse5x. Another good news is that a new Auto Update Channel is currently being rolled out (March 2017). This means that all software updates with

new and optimized features will be made available to all Zfx™ Authorized Milling Labs automatically and at the same time. Along with the updates, the laboratories will receive information about new hardware and equipment like milling tools etc. required to make use of the new features.

HIGHLIGHTS HYPERDENT®

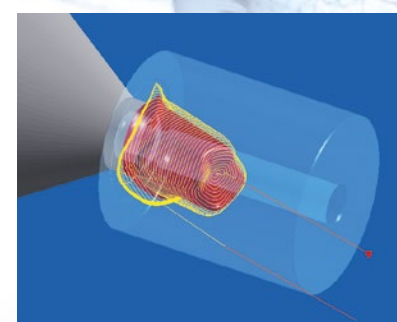

NEW: *hyperDENT*® V8

The latest *hyperDENT*® version comes with a newly designed, easier-to-personalise user interface and offers improved functions for highly efficient milling. One of its completely new features is the ability to load several blanks at once and calculate milling paths and tool changes across all blanks. This increases the efficiency of prefabricated abutment milling as multiple abutments may be milled in a single procedure.

hyperDENT®
V8

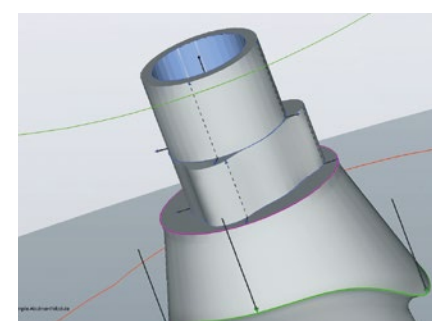

hyperDENT®: Implant Module

The production of screw-retained implant-based bars and bridges is highly demanding in terms of accuracy. Top features in the *hyperDENT*® Implant Module used to ensure the required precision include a function for separate screw channel machining and an automated geometry exchange mechanism. The latter replaces the CAD dummy geometry with a millable interface geometry deposited in the CAM software.



More about
hyperDENT® V8 online at
www.follow-me-tech.com



Together, let's do more.

A successful dental practice starts with teamwork. A precision team you build from within. And a formidable ally to help achieve exceptional outcomes for your patients and your practice. At Zimmer Biomet Dental, we've been pushing the boundaries of oral health for over 63 years now. We can do the same for you.

When you choose Zimmer Biomet Dental, extraordinary things can happen. Our heritage of quality products, innovative solutions, service and support enables you to rethink where you are and focus on where you want to be.

It's all possible with Zimmer Biomet Dental.

Expect more. Call +34-93-470-55-00 for more information.

zimmerbiometdental.com

All references to Zimmer Biomet Dental contained herein refer to the dental subsidiaries of Zimmer Biomet Holdings, Inc. Unless otherwise indicated, as referenced herein, all trademarks are the property of Zimmer Biomet. This material is intended for clinicians only. ZB0127 REV A 01/17 ©2017 Zimmer Biomet, All rights reserved.



GLOBAL NETWORK





Zfx GmbH
Kopernikusstraße 27
85221 Dachau, Deutschland
Tel. +49 81 31 33 244
Fax +49 81 31 33 244
order@zfx-dental.com



FOLLOW-ME! Technology GmbH
Regerstraße 27
81541 München, Deutschland
Tel +49 89 452 170 60
Fax +49 89 452 170 69
info@follow-me-tech.com

Imprint:
Publisher and responsible for the contents:
Zfx GmbH (Dachau, Germany). Layout and
Concept: Kapitel4 GmbH (Lustenau, Austria).
Text: Olivia Besten (Köln, Germany)